

Transfer Valve Body COMPONENTS

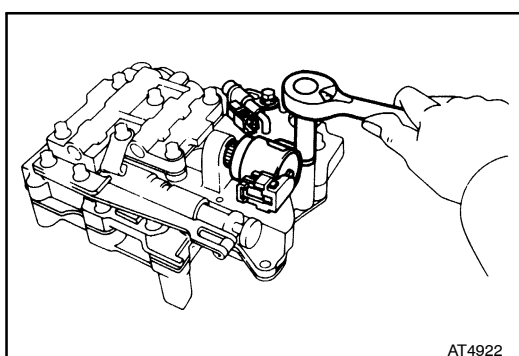

(Disassembly of Transfer Valve Body)

1. **REMOVE NO. 4 SOLENOID**
 - (a) Remove the bolt and No. 4 solenoid.
 - (b) Remove the O-ring from the solenoid.
2. **(w/ A.D.D.) REMOVE TRANSFER PRESSURE SWITCH**

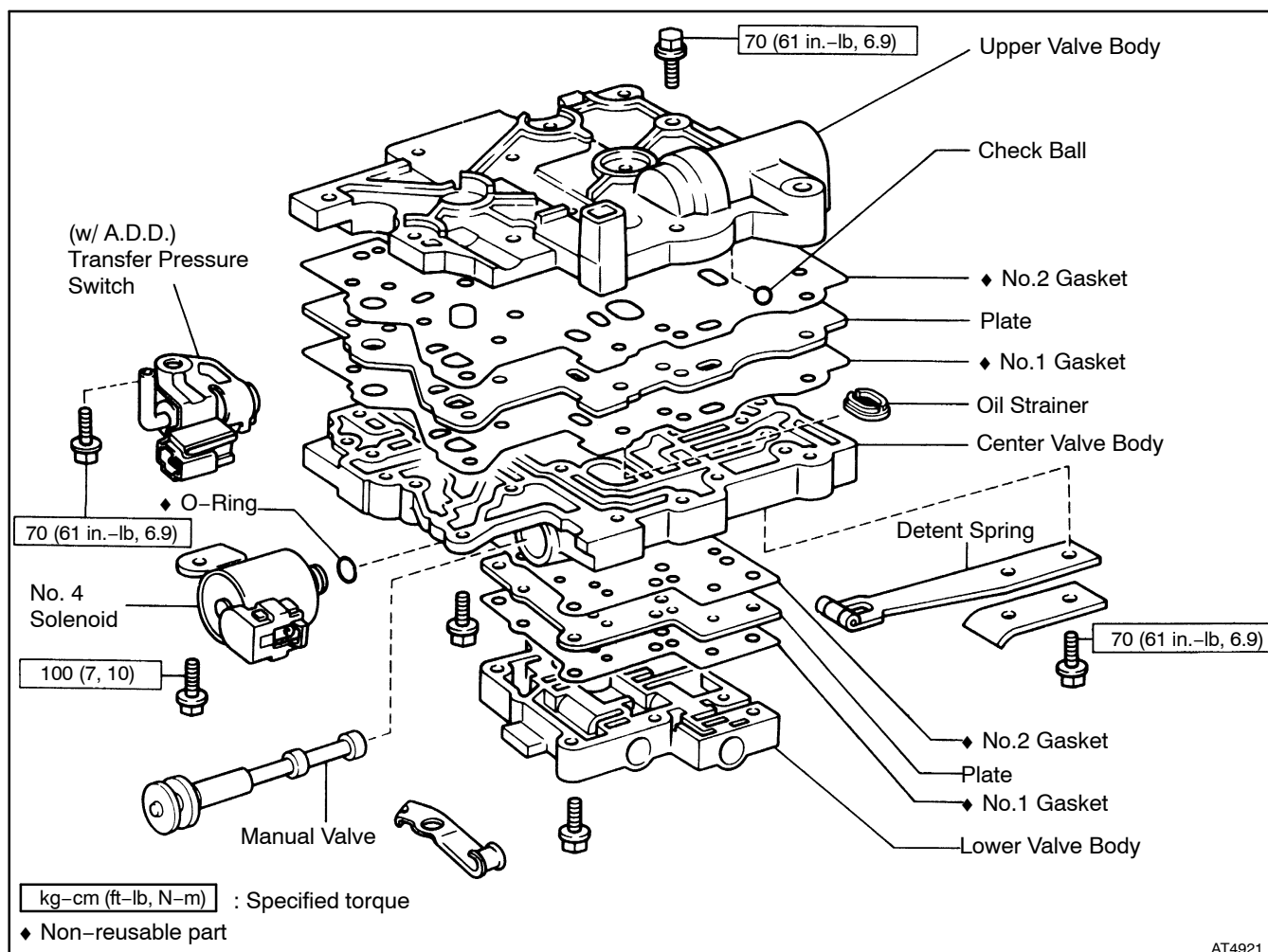
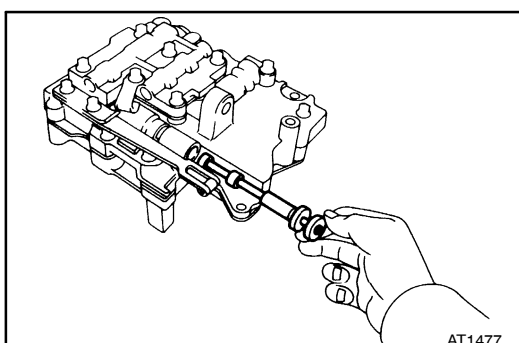

3. **REMOVE MANUAL VALVE**

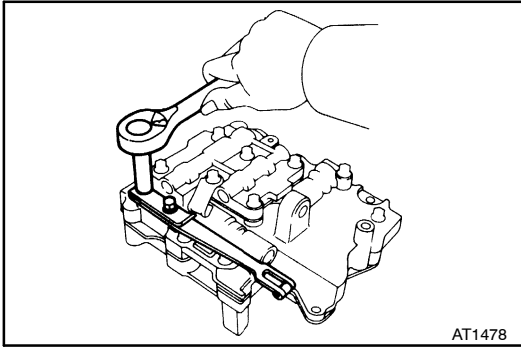
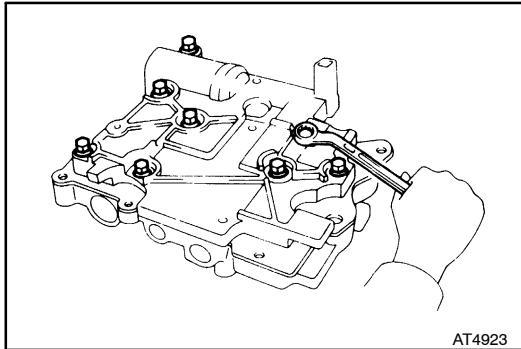
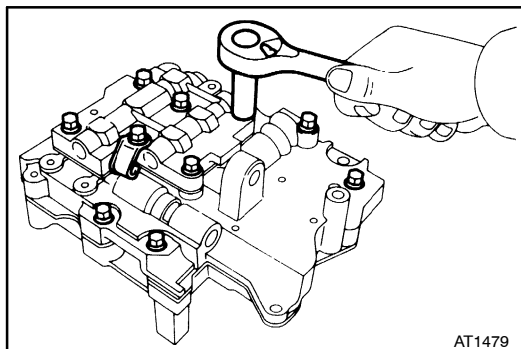
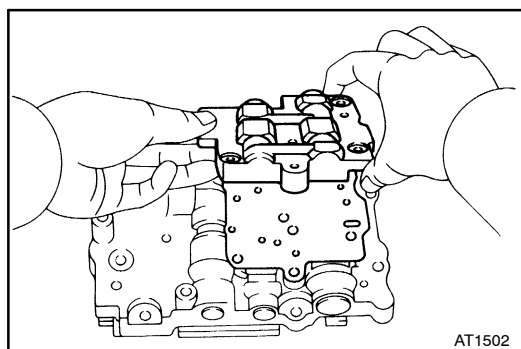
**4. REMOVE DETENT SPRING****5. REMOVE EIGHT BOLTS FROM UPPER VALVE BODY****6. TURN ASSEMBLY OVER AND REMOVE TEN BOLTS FROM LOWER AND CENTER VALVE BODIES****7. LIFT OFF LOWER VALVE BODY**

- (a) Remove the lower valve body.
- (b) Remove the plate and two gaskets.

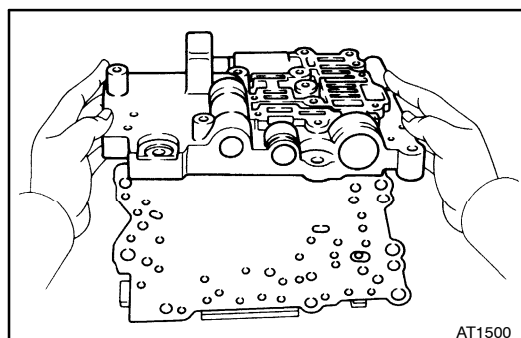
**8. LIFT OFF CENTER VALVE BODY**

- (a) Remove the center valve body.
- (b) Remove the plate and two gaskets.